

SAFETY HEALTH AND ENVIRONMENTAL (SHE) INFORMATION
 Based upon the assumption that all works will be undertaken by competent contractors working under appropriate, approved method statements, the designer would draw the user's attention to the significant residual SHE risks that have not been eliminated from the design process or are inherent in the design process.
CONSTRUCTION, OCCUPANCY AND DEMOLITION
 List below the significant residual risks for EACH of these three phases of operation.
 These are not intended to be an exhaustive list of SHE risks. The user should refer to the SHE risk register for further information.
 The user should ensure that the SHE risk register is updated as the project progresses.

| Category | Area (m²) |
|---|----------------|
| Existing Gross Building Area (Footprint area on site) | 2016m² |
| Proposed Gross Building Area (Footprint area on site) | 270 m² |
| Soft Play (informal & social) | 5604m² |
| Hard Play (informal & social) | 1689 m² |
| Habitat | 731m² |
| Float (car park, roads, etc) | 967m² |
| Total | 11051m² |

LEGEND
 B01 Main Building
 B02 Early Years Education Building
 Site total Area = 11051m2

FRONT CAR PARKING AREA:

1.0 Disabled car-parking bay line markings in new location as indicated. Existing fencing to be realigned around new bay area.

FOUL DRAINAGE ABOVE GROUND KEYS

- Floor drains in rubber flooring as R11/251

DRAINAGE BELOW GROUND

- Clay pipelines for foul water drainage generally as R12/121
 - Clay pipelines for surface water drainage generally as R12/122

- 1 No New cycle racks 3mx4m cap No10; phase 3 as Q50/213A
- Fire brigade access, all gates to have 3.1m clear opening.
- 1 No New small cycle/scooter racks cap No10, size Ø 1.5m; phase 3 as NBS Q50/213B
- 2 No New small cycle shelter size 1mx3.5m cap No 5; phase 3 as NBS50/213B
- New 1500m high bow top gates as NBS 40/570A & NBS 40/570B ; phase 1
- New 1500m high bow top Fence 50m; phase 1
- New Soft play area 180m2; phase 1 as NBS Q26/360 sub-base as Q22/125a
- New 1500m high bow top gates; phase 1 as NBS Q50/434. Gates clear opening 3.0m
- New canopy to be rebuild and resized 3mx8m approx; phase 1
- PC Concrete kerb as Q10/111
- New 3 No Maple (acers) trees to be planted to BS 8545:2014 Trees: from nursery to independence in the landscape Acer campestre Queen Elizabeth – 14/16cm 40 Litre container grown (minimum container size) Acer platanoides Cleveland – 14/16cm 40 Litre container grown minimum size (minimum container size); phase 1
- PC Edging as Q10/105
- New sand pit as Q52/410; phase 1
- New 1500m high bow top gates; phase 1 as NBS Q40/434
- New Soft play to existing tarmac area 38m2; phase 1 as NBS Q26/361
- 3 No New cycle/scooter racks cap No10, size Ø 1.5m; phase 3 as NBS Q50/215

FENCING KEYS

- Gate in railings to match existing new controlled entry gate, height 1800 mm as Q40/121
- Open mesh steel panel fencing to play areas, height 1500 mm as Q40/125C
- Open mesh steel panel fencing to security, height 2200 mm as Q40/125D
- Open mesh steel panel general purpose fencing existing to be modified / moved, height 2400 mm as Q40/125E
- Proprietary fencing bowtop fencing as Q40/434
- Gates pedestrian as Q40/570A
- Gates vehicles as Q40/570B

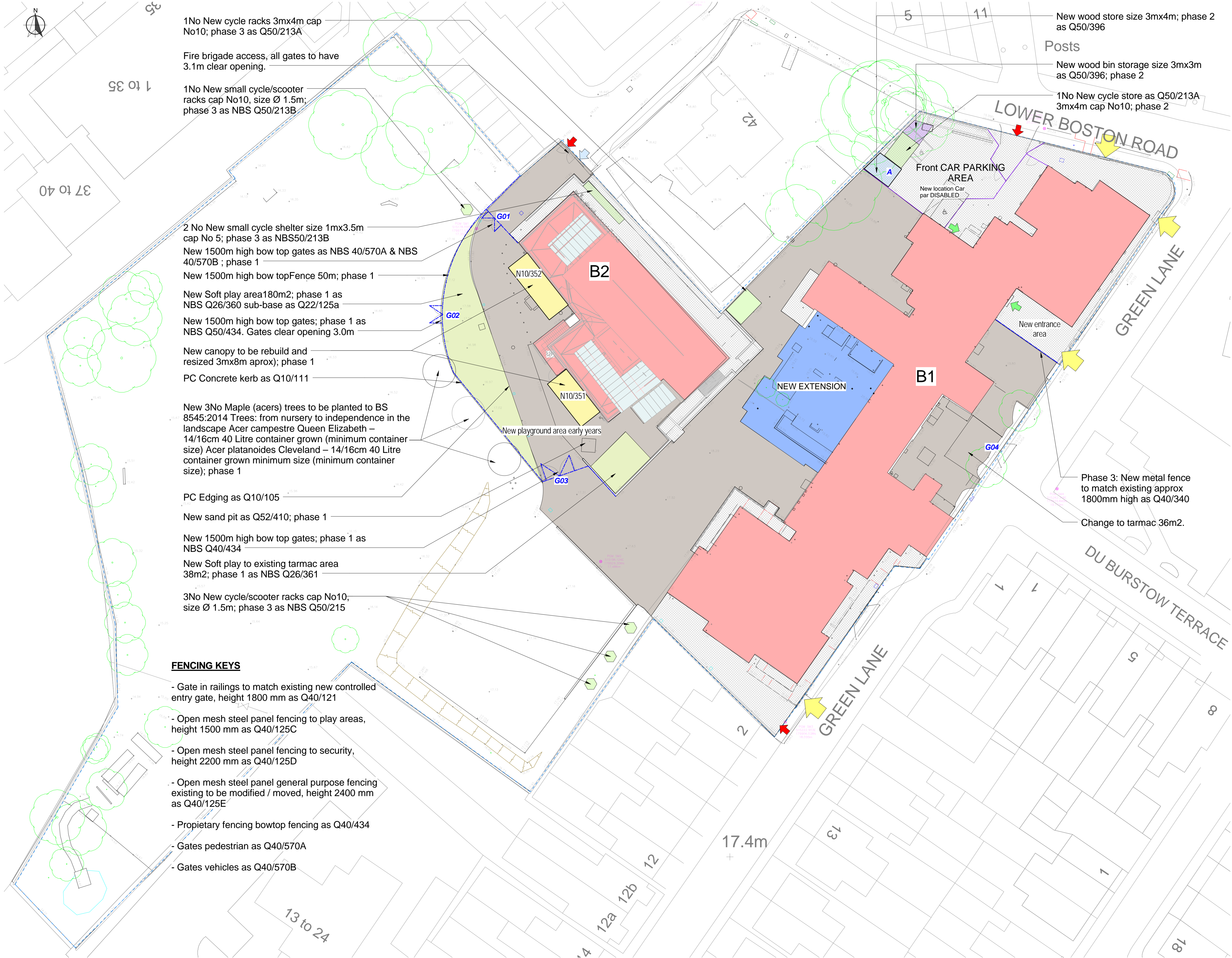

New wood store size 3mx4m; phase 2 as Q50/396
 Posts
 New wood bin storage size 3mx3m as Q50/396; phase 2
 1 No New cycle store as Q50/213A 3mx4m cap No10; phase 2

LOWER BOSTON ROAD

GREEN LANE

Phase 3: New metal fence to match existing approx 1800mm high as Q40/340
 Change to tarmac 36m2.

DU BURSTOW TERRACE