

SAFETY HEALTH AND ENVIRONMENTAL (SHE) INFORMATION

Based upon the assumption that all works will be undertaken by compliant contractors working under appropriate, approved method statements, the designer should draw the user's attention to the significant residual SHE risks that have not been eliminated from the design process or this drawing by the design process.

CONSTRUCTION, OCCUPANCY AND DEMOLITION
 (List below the significant residual risks for EACH of these three phases of operation).
 (These are not intended to be an exhaustive list of risks, but to highlight those risks that are considered to be significant.)

- Occupancy Areas Key**
- Classroom Base
 - Kitchen
 - Learning Resource

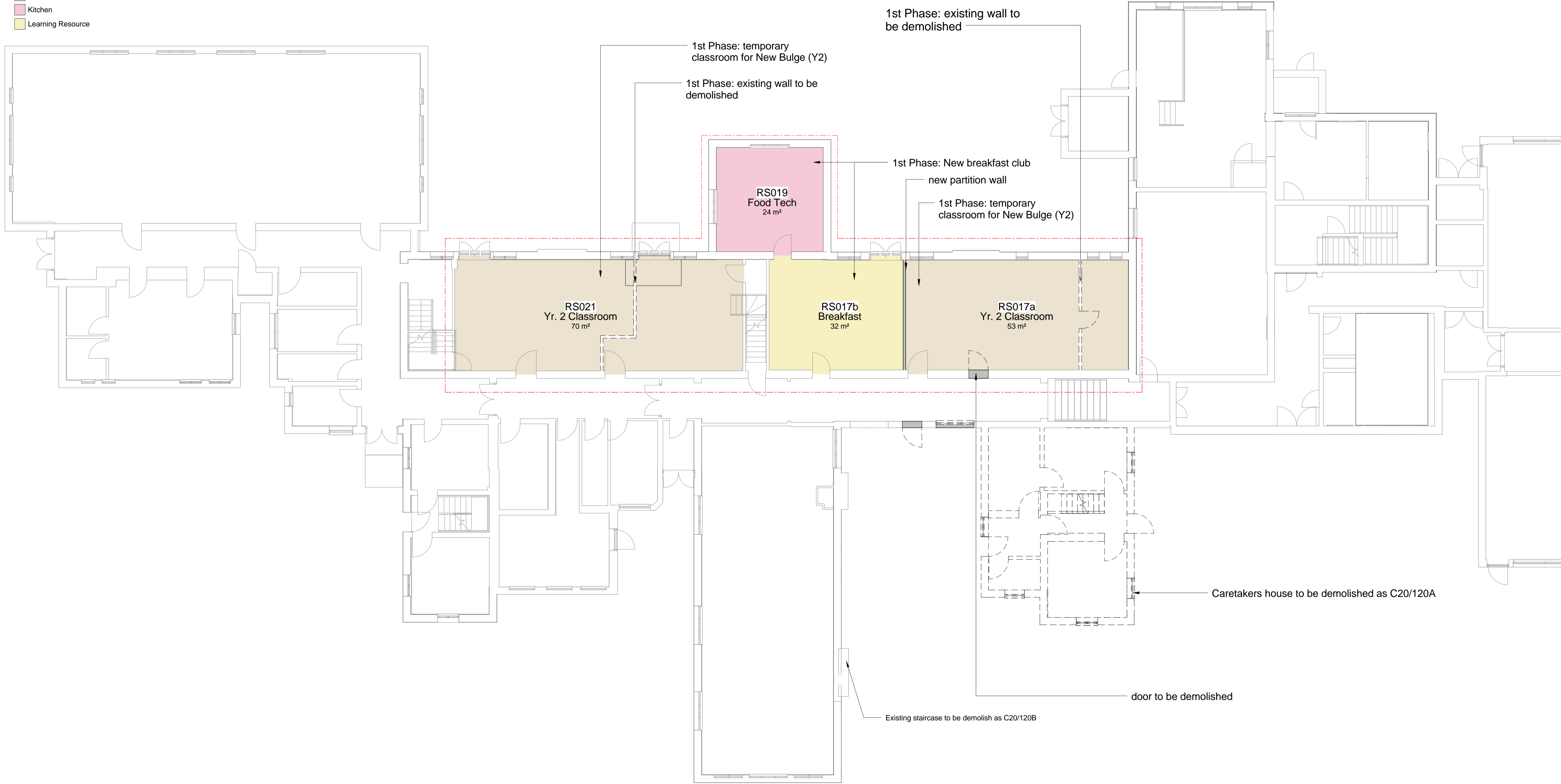

1 Proposed Ground Floor/BI (Phase 1)
 AB-101 1 : 100

Rev No.	Comments	Date

Client:
London Borough of Ealing

Project title:
St Mark's Primary School Lower Boston Road, Hanwell, W7 2NR

Drawing title:
Proposed GF/B1 (Phase 1)

Drawing status:
TENDER

Job No.: EC1099 Project co-ordinator:

Scale: @A1 1 : 100 Date: January 2016

Drawn by: Author Checked by: Checker

Dwg No.: AB - 101 Rev No.: _____